

SHARP OPERATION MANUAL

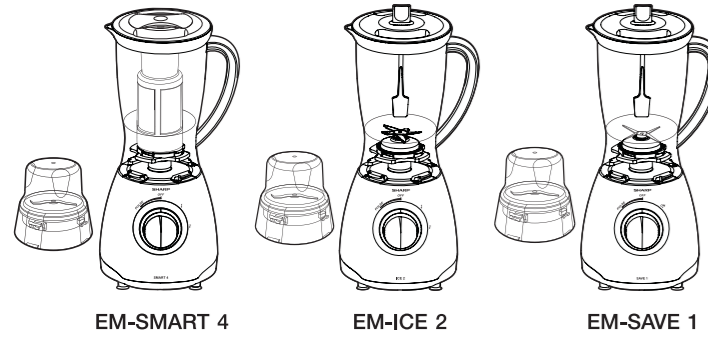

EM-SMART 4 EM-ICE 2 EM-SAVE 1

BLENDER MODEL EM-SMART 4 (with filter) EM-ICE 2 EM-SAVE 1

CONTENTS	PAGE
USAGE PRECAUTIONS	10
DESCRIPTION OF PARTS	11
SPECIFIC INFORMATION	11
HOW TO USE	12-13
MOTOR PROTECTION SYSTEM	14
CLEANING AND MAINTENANCE	16
HOW TO KEEP THE POWER CORD	16

Please see the date of manufacture marked on the product
Thank you for your trust in products of Thai City Electric Co., Ltd.
In order to use blender in efficiency way. Please read the
instructions manual carefully before using this appliance.

USAGE PRECAUTIONS

Please read the warning and cautions carefully before using this appliance and comply strictly for your own safety and to prevent the damage that may occur on your property.

WARNING

- Do not switch on when the blender jug or the grinder is not attached to the motor housing.
- Do not remove the blender jug or the grinder is still operating.
- Do not use sharp material such as polished fiber to clean this appliance. Use cloth.
- The grinder is not appropriate to grind hard ingredients such as ice cubes as well as liquid ingredients.
- Very important :** Do not rinse or immerse the motor housing in water because it may cause electric shock and material damage.
- Do not place any material or hand inside the blender jug when the unit is operating.
- Do not leave the unit during operation.
- Always unplug the appliance from the outlet before cleaning or when not in use.
- If the appliance is malfunction. Do not try to repair this appliance. For your own safety and using this appliance with high efficiency, contact the nearest SHARP service facility for repair.
- Always switch off before removing the blender jug or the grinder from motor housing.
- Do not plug in if you have wet hands because it may cause injury from leakage current.
- This appliance is not intended for use by persons (including children) with reduced physical, sensory or mental capabilities, or lack of experience and knowledge, unless they have been given supervision or instruction concerning use of the appliance by a person responsible for their safety.
- Children should be supervised to ensure that they do not play with the appliance.

CAUTIONS

- In case of the power cord is broken, it must be replaced by manufacturer or appointed service providers or equivalent professionals to avoid any damages.
- Keep out of reach of children to protect them from sharp blades.
- Do not exceed the maximum capacity of the blender jug or the grinder.
- High temperature ingredients should be cooled down before filling in the blender jug or the grinder.
- Always handle plug on safety part when plug in or unplug. Never pull the power supply cord to disconnect plug from the socket because it may cause the power cord damage.
- Do not plug in other electronic equipment in the same socket because the socket will overheat and may result in fire.

DESCRIPTION OF PARTS

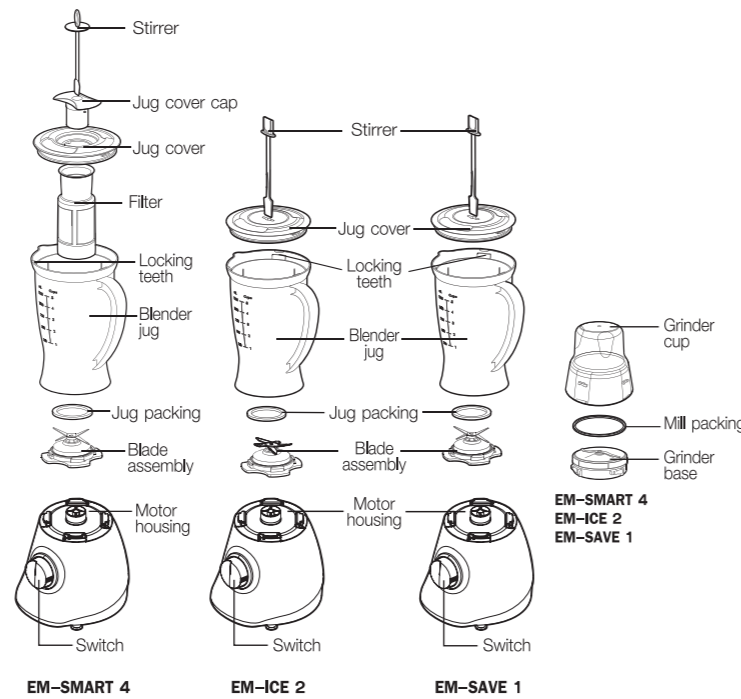

EM-SMART 4 EM-ICE 2 EM-SAVE 1

SPECIFIC INFORMATION

MODEL	EM-SMART 4	EM-ICE 2	EM-SAVE 1
Blender jug capacity (ml.)	1,250		
Grinder cup capacity (g.)	50		
Power consumption (W)	450		
Rated voltage (V)	220		
Rated frequency (Hz)	50		
Total weight (Kg.)	2.0	1.9	
Product dimension (W x H x D) (mm.)	202 x 401 x 194	202 x 396 x 194	
Switch	4 modes (PULSE/OFF/1/2)		3 modes (PULSE/OFF/ON)
Rust-free stainless steel blades	4 blades	5 serrated blades	4 blades
Accessories	Stirrer		

* Detail is subject to change without prior notice.

HOW TO USE

Be sure that the rated voltage is 220 V only before use.

Instructions for blade assembly

- Place the blade assembly in the underside of the blender jug.
- Twist the blade assembly by following the lock arrow direction in order to tighten the lock.

Make sure that the jug packing is on top of the blade assembly in right position.

- Note**
- Underneath the blade assembly, there is an arrow to indicate the direction to open and to lock the blade assembly.
 - Before placing the blade assembly in to the blender jug, please make sure the jug packing is in place to prevent water leakage.
 - After placing the blade assembly, test by filling plain water into the blender jug. If it is not tight, water will leak out.

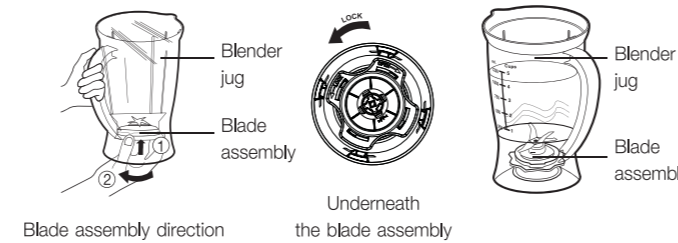

Blade assembly direction Underneath the blade assembly

Instructions for removing the blade assembly from blender jug

- Insert your finger into the underside of the blender jug to handle the blade assembly.
- Twist the blade assembly by following the open arrow to remove the blade assembly from blender jug and pull it away from underside of the blender jug.

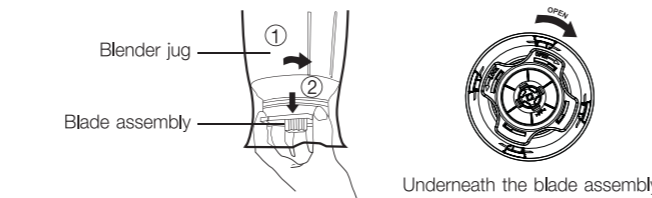

Blender jug Blade assembly Underneath the blade assembly

Instructions for using blender with the filter (Model EM-SMART 4 only)

- Place the filter into the blender jug and cover the jug cover in order to press the top of the filter so that the filter will be in safe position when operating.
- Add the ingredients (as desired to extract) to the filter and insert the jug cover cap or the stirrer in order to prevent the ingredients spill out the blender jug.
- Follow the instructions no.2 in "Using your blender".

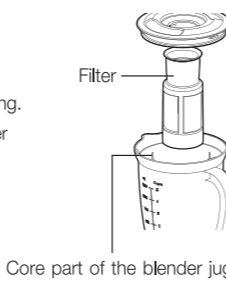

Filter Core part of the blender jug

Speed selection

Model EM-SMART 4, EM-ICE 2

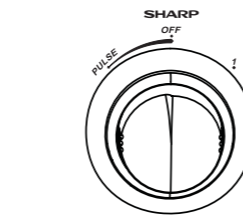

- Choose an appropriate speed for your desired food.
- OFF : Turn off
Speed level 1 : For liquid food such as milk.
Speed level 2 : For solid food mix with liquid food.
PULSE : For quick blending at a time for each pulse. (When release a hand, the button will turn to the OFF position)

Model EM-SAVE 1

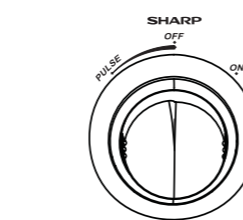

- Choose an appropriate speed for your desired food.
- OFF : Turn off
ON : For solid food mix with liquid food.
PULSE : For quick blending at a time for each pulse. (When release a hand, the button will turn to the OFF position)

Instructions for covering the jug cover onto the top of blender

Cover the blender jug cover (as shown in the picture) and attach locking teeth to blender by rotating in clockwise direction until close firmly.

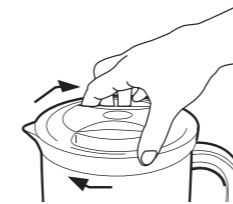

Instructions for using the stirrer

Insert the stirrer through the hold on the jug cover to stir the ingredients in blender jug.

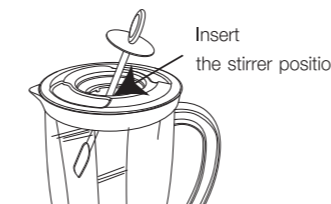

EM-SMART 4

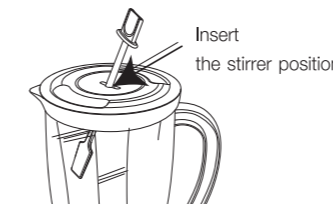

EM-ICE 2, EM-SAVE 1

USING YOUR BLENDER

	1 Add all required ingredients to the blender jug. If it needed to use blender jug with filter. • Please see in "instruction for using blender with the filter" (Model EM-SMART 4 only) Note Do not crush ice over than 5 ice cubes (EM-SMART 4, EM-SAVE 1) Do not crush ice over than 12 ice cubes (EM-ICE 2)
	2 Place the blender jug on the motor housing and rotate the jug in clockwise direction until locked. Note If the blender jug is not correctly locked, the motor will not work.
	3 Push the jug cover onto the top of the blender jug and plug in power cord properly. • Please see in "instruction for covering the jug cover onto the top of blender" Note Make sure the switch is at the OFF position every time before plug in.
	4 Turn the switch to the 1, 2 or PULSE position (Model EM-SMART 4, EM-ICE 2) as your desired speed or ON, PULSE position (EM-SAVE 1) to start using the blender. • Please see in "Speed selection" Note Do not use the blender without the jug cover. Do not operate the blender for longer than 2 minutes. After each 2 minutes session the blender must be allowed to cool down at least 1 minute before next operation.
	5 Turn the switch to the OFF position when finish using.
	6 Rotate the blender jug as anti-clockwise direction and lift it off the motor housing.

MOTOR PROTECTION SYSTEM

In the event of an overload condition, the motor protection system will shut down the motor immediately. Turn off the switch and remove a portion of the food which has been added in the blender jug. Then, press "RESET" button underneath the base before turn it on again.

USING YOUR GRINDER

	1 Turn the grinder cup up and add the desired ingredients to the cup. Note The grinder cup is not appropriate to grind some liquid ingredients.
	2 Cover with the grinder base turn anti-clockwise to lock tightly.
	3 Place the grinder cup on the motor housing and turn clockwise until it locked. Note If the grinder cup is not correctly locked, the motor will not work
	4 Plug in power cord properly. Note Please ensure that switch is at the OFF position before plug in.
	5 Turn the switch to the 1, 2 or PULSE position (Model EM-SMART 4, EM-ICE 2) as your desired speed or turn the switch ON, PULSE position (EM-SAVE 1) to start using the blender. Note Do not operate the grinder for longer than 2 minutes. After each 2 minutes session the grinder must be allowed to cool down at least 1 minute before next operation.
	6 Turn the switch to the OFF position when finish using.
	7 Rotate the grinder cup as anti-clockwise direction and lift it off the motor housing.

CLEANING AND MAINTENANCE

Blender jug

Fill a half jug blender of water or mix with small amount of dishwashing liquid and cover with the jug cover. Place on the motor housing then turn the switch to PULSE position for a moment and release, repeat it (Model EM-SMART 4, EM-ICE 2, EM-SAVE 1). Then, lift the blender jug away from the base. Remove the blade assembly, rinse with clean water and dry thoroughly with soft dry cloth.

Note

Take care when handling the sharp blade. It may cause injury particularly when cleaning.

Grinder base and grinder cup

Rinse with clean water and dishwashing liquid, use soft brush to clean then dry thoroughly with soft dry cloth.

Filter (Model EM-SMART 4)

Remove the filter from the blender jug, rinse with clean water or mix with small amount of dishwashing liquid, clean with soft brush in order to clean mesh wire area.

Motor housing

Use a clean damp cloth to clean the motor housing.

HOW TO KEEP THE POWER CORD

After use, keep the power cord into cord storage and insert the plug into lock position.

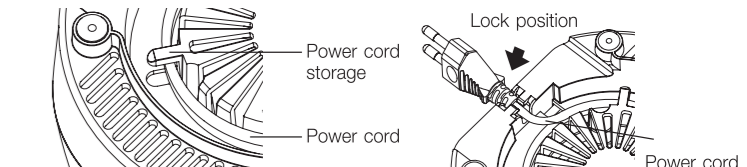

Note Do not keep the power cord when the motor housing is still hot. Periodically check the power cord and plug for any sign of damage.

Sole Distributor in Thailand

MANUFACTURED BY WESTERN APPLIANCES CO., LTD.
97 Moo 20 Sala Daeng, Bang Nam Pheo, Chachoengsao 24000

THAI CITY ELECTRIC
THAI CITY ELECTRIC CO., LTD.
1643/4 New Petchburi Rd., Makkasan, Ratchathewi, Bangkok 10400
Tel. 0 2333 3111 Call Center 0 2254 5000
E-mail : callcenter@thaicity.co.th

คิดบวก ทำบวก
เพื่อเด็ก และสังคมไทย
WWW.THAI-CITY-SOCIAL.COM

www.thaicity.co.th
www.sharp-weeeclub.com
www.facebook.com/sharpweeeclub