

# SHARP OPERATION MANUAL

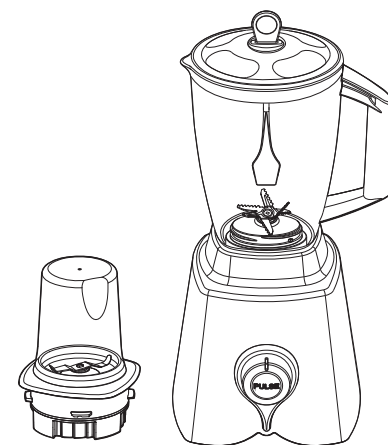

BLENDER  
MODEL EM-ICE POWER

CONTENTS	PAGE
USAGE PRECAUTIONS	10
DESCRIPTION OF PARTS	11
SPECIFIC INFORMATION	11
HOW TO USE	12-15
MOTOR PROTECTION SYSTEM	16
CLEANING AND MAINTENANCE	16
HOW TO KEEP THE POWER CORD	16

Please see the date of manufacture marked on the product

Thank you for your trust in products of Thai City Electric Co., Ltd. In order to use blender in efficiency way. Please read the instructions manual carefully before using this appliance.

## USAGE PRECAUTIONS

Please read the warning and cautions carefully before using this appliance and comply strictly for your own safety and to prevent the damage that may occur on your property.

### WARNING

- Do not switch on when the blender jug or the grinder is not attached with the motor housing.
- Do not remove the blender jug or the grinder while unit is running.
- Do not use sharp material such as polished fiber to clean this appliance. Wipe it with soft damp cloth.
- The grinder is not appropriate to grind hard ingredients such as ice cubes and liquid ingredients.
- Very important** : Do not rinse or immerse the motor housing in water because it may cause electric shock and material damage.
- Do not place any material or hand inside the blender jug when the unit is operating.
- Do not let the appliance run unattended.
- Always unplug the appliance from the wall outlet before cleaning or when not in use.
- If the appliance is malfunction. Do not try to repair this appliance. For your own safety and using this appliance with high efficiency, contact the nearest SHARP service facility for repair.
- Always switch off before removing the blender jug or the grinder from motor housing.
- Do not plug in if you have wet hands because it may cause injury from leakage current.
- This appliance is not intended for use by persons (including children) with reduced physical, sensory or mental capabilities, or lack of experience and knowledge, unless they have been given supervision or instruction concerning use of the appliance by a person responsible for their safety.
- Children should be supervised to ensure that they do not play with the appliance.

### CAUTIONS

- In case the power cord is broken, it must be replaced by manufacturer or appointed service providers or equivalent professionals to avoid any damages.
- Keep the appliance out of reach of children to protect them from sharp blades.
- Do not exceed the maximum capacity of the blender jug or the grinder.
- High temperature ingredients should be cool down before filling in the blender jug or the grinder.
- Always handle plug on safety part when plug in or unplug. Never pull the power supply cord to disconnect plug from the wall outlet because it may cause the power cord damage.
- Do not plug in other electronic equipment on the same wall outlet the wall outlet will overheat and lead to fire.

## DESCRIPTION OF PARTS

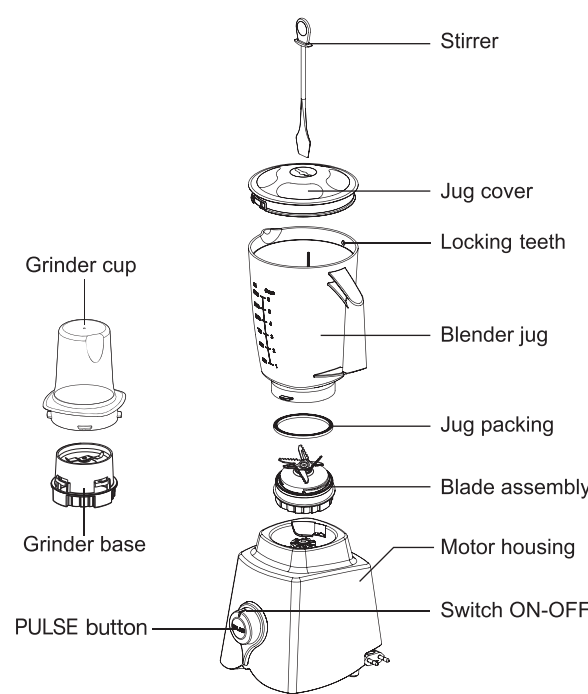

## SPECIFIC INFORMATION

MODEL	EM-ICE POWER	
Blender jug capacity (ml.)	1,500	
Power consumption (W)	600	
Rated voltage (V)	220	
Reted frequency (Hz)	50	
Swirling of motor	Continuous (Operate blender for 2 minutes and cool down for 1 minutes) Only when using PULSE mode.	
Outside dimension (WxHxD) (mm.)	Blender and motor housing	216 x 400 x 207
	Grinder and motor housing	182 x 293 x 207
Weight (Kg.)	Blender and motor housing	2.5
	Grinder and motor housing	2.3
Switch	3 modes (OFF / 1 / 2) additional PULSE	
Rust-free stainless steel blades	6 serrated blades	
Accessories	Stirrer	

\*Detail is subject to change without prior notice.

## HOW TO USE

Be sure that the rated voltage is 220V only before use.

### Instructions for using the stirrer

Insert the stirrer through the hole on the jug cover to stir the ingredients in blender jug.

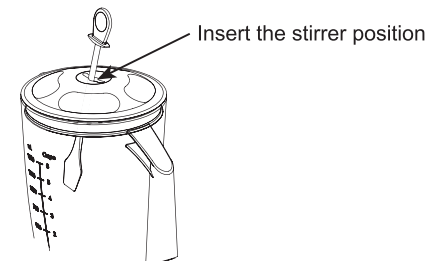

### Instructions for covering the jug cover

Put the jug cover on the blender jug and turn it in clockwise direction (as shown in the picture) until it lock firmly.



### Instructions for assembling the blades

- Place the blade assembly at the bottom of the blender jug.
- Twist the blade assembly in clockwise direction or by following the lock (Turn it clockwise) arrow in order to tighten the lock. Make sure that the jug packing is on the top of the blade assembly in right position.

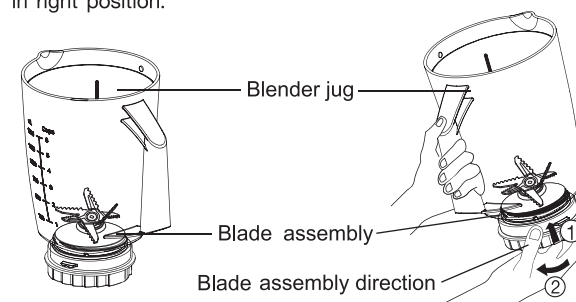

- Note**
- Below the blade assembly, there is an arrow indicated the direction to OPEN and to LOCK the blade assembly.
  - Before placing the blade assembly into the blender jug, please make sure the jug packing is in place to prevent water leakage.
  - After placing the blade assembly, test by filling plain water into the blender jug. If it is not tight, water will leak out.

### Instruction for removing the blades assembly from blender jug

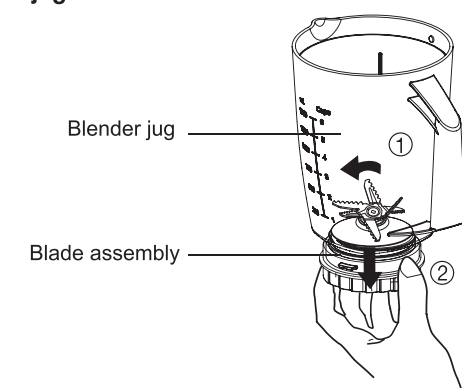

- Hold the blade assembly firmly. Then, twist it in anti-clockwise direction or follow the open-arrow to remove the blade assembly from blender jug.
- Pull it away from underside of the blender jug.
- You can now remove the jug packing from the blade assembly.

### Caution

- Blades are very sharp. It can cause injury if handled incorrectly. The jug packing can easily be irreparably damaged by the blade assembly.
- Do not use much pressure when removing blade assembly from the blender jug. Till it slightly when removing.

### Speed selection

Choose appropriate speed for your desired food.

**Off** : for switch off the appliance

**Speed level 1** : for liquid blending.

**Speed level 2** : for food concentrated spin.

**Pulse** : for quick blending.

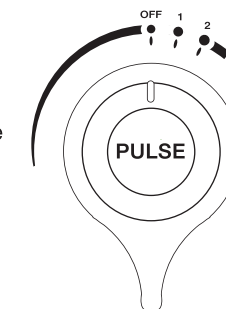

### Tip

- The speed buttons allow you to choose the right speed to obtain optimal results. Suggested to start from speed level 1 then level 2.
- Press PULSE button with speed level 1 for a few seconds at a time to increase speed. Use speed level 2 with PULSE speed dose not increase. When release the button, the speed will return to normal.
- Press the PULSE button as often as is necessary.

## USING YOUR BLENDER

	<b>1</b> Add all required ingredients to the blender jug. <b>Note</b> Do not crunch ice cubes more than 12.
	<b>2</b> Place the blender jug on the motor housing which can place in 4 positions and rotate the blender jug in clockwise direction until locked. <b>Note</b> If the blender jug is not correctly locked, the motor will not work.
	<b>3</b> Put the jug cover on the top of the blender jug and plug in power cord properly. • Please see "Instruction for covering the jug cover". <b>Note</b> Make sure the switch is in the OFF position every time before plug in.
	<b>4</b> Turn the switch to the 1, 2 or to press PULSE as your desired speed to start the blender. • Please see in "Speed selection". <b>Note</b> Do not use the blender without the jug cover. Do not operate the blender longer than 2 minutes. After each 2 minutes session the blender must be allowed to cool down at least 1 minute before next operation.
	<b>5</b> Turn the switch to the OFF position when finished using.
	<b>6</b> Rotate the blender jug in anti-clockwise direction and lift it off the motor housing.

## USING YOUR GRINDER

	<b>1</b> Turn the grinder cup up and add the desired ingredients to the grinder cup. Do not exceed the maximum level indicated on the grinder cup beaker. <b>Note</b> The grinder cup is not appropriate to grind some liquid ingredients. Never use the grinder to grind very hard ingredients as frozen food or meat with bones.
	<b>2</b> Cover the grinder cup with the grinder base and turn anti-clockwise to lock tightly.
	<b>3</b> Place the grinder cup on the motor housing which can place in 4 positions and rotate the grinder cup in clockwise direction until locked. <b>Note</b> If the grinder cup is not correctly locked, the motor will not work.
	<b>4</b> Plug in power cord properly. <b>Note</b> Please ensure that switch is in the OFF position before plug in.
	<b>5</b> Turn the switch to the 1, 2, or to press PULSE as your desired speed to start using the grinder. <b>Note</b> Do not operate the grinder longer than 2 minute. After each 2 minute session the grinder must be allowed to cool down at least 1 minute before next operation.
	<b>6</b> Turn the switch to the OFF position when finished using.
	<b>7</b> Rotate the grinder cup in anti-clockwise direction and lift it off the motor housing.

### RECOMMENDATION FOR USING GRINDER

INGREDIENTS	MAX QUANTITY (g)	TIME (sec.)
Paprika	40	5
Pepper	80	30
Rice	100	30
Peanut	80	10
Pork (cut into pieces)	100	30

**Note** Use the spin speed level 2.

MANUFACTURED BY WESTERN APPLIANCES CO., LTD.  
97 Moo 20 Sali Daeng, Bang Nam Piao, Chachoengsao 24000

## MOTOR PROTECTION SYSTEM

This blender is equipped with a motor protection system that will switch off the motor in case of an overload condition. If this happens, switch off and remove a portion of the ingredients which has been added in the blender jug. Then, press "RESET" button underneath the base before turning it on again.

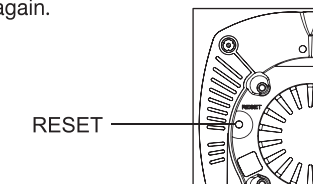

## CLEANING AND MAINTENANCE

### Blender jug

- Pour half jug with water filled with few drops of detergent. Then, cover the jug with the jug cover and place it on the motor housing. Push the PULSE button a few times.
- Detach the jug from the motor housing and remove the blade assembly. Rinse them with clean water and dry them with soft dry cloth.
- Note** Be careful when holding the sharp blade. It may cause injury particularly when cleaning.

### Grinder base and grinder cup

- Rinse the grinder with clean tap water and dishwashing liquid, use soft brush to clean then dry thoroughly with soft dry cloth.

### Motor housing

- Use a clean damp cloth to clean the motor housing.

## HOW TO KEEP THE POWER CORD

You can store excess main cord at the back of the appliance by holding the plug and pull it out. The plug will automatically push back into the cord storage compartment.

**Note** Periodically check the power cord and plug for any sign of damage.

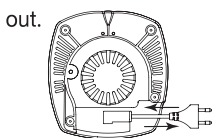

Sole Distributor in Thailand

THAI CITY ELECTRIC  
THAI CITY ELECTRIC CO., LTD.  
1643/4 New Petchburi Rd., Makasan, Ratchathewi, Bangkok 10400  
Tel. 0 2333 3111 Call Center 0 2254 5000  
E-mail : callcenter@thaicity.co.th

www.thaicity.co.th  
www.sharp-weclub.com  
www.facebook.com/sharpweclub